

ITEM NO.	PART NUMBER	DESCRIPTION	QTY.
1	023001-M-001	HOOP SECTION	4
2	023001-M-007	BACKER PLATE	4
3	023001-MA-001	LEG WELDMENT	4
4	91257A994	1"-14 X 8" HEX HEAD BOLT	16
5	90499A855	1"-14 HEX NUT	16
6	98038A282	1" WASHER	32

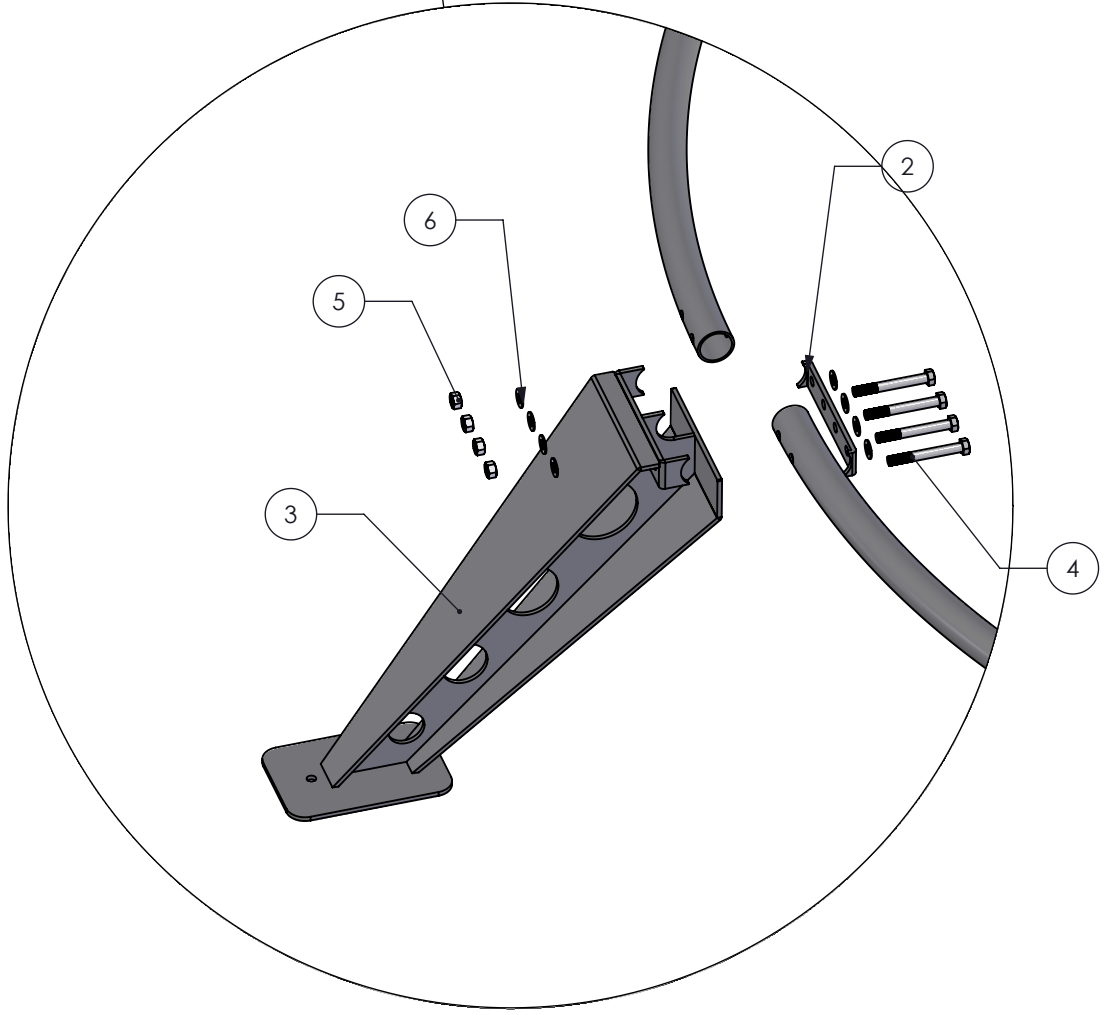

The attached information is the exclusive property of UGLS and is protected under the copyright laws of the United States and other countries. All persons to whom this information is shared agree that they will not make use of, or disclose to any third party, this information without the expressed written permission of UGLS. Any unauthorized use of this information may constitute a violation of the United States Copyright Act.

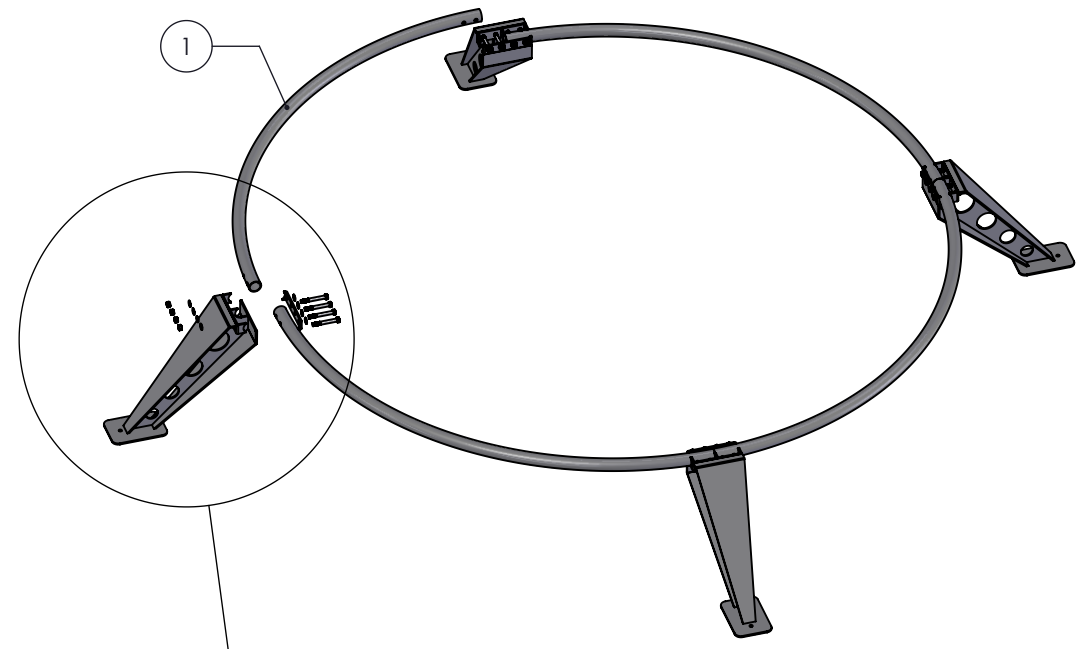
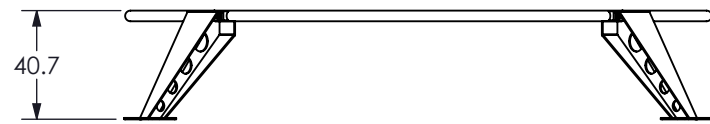
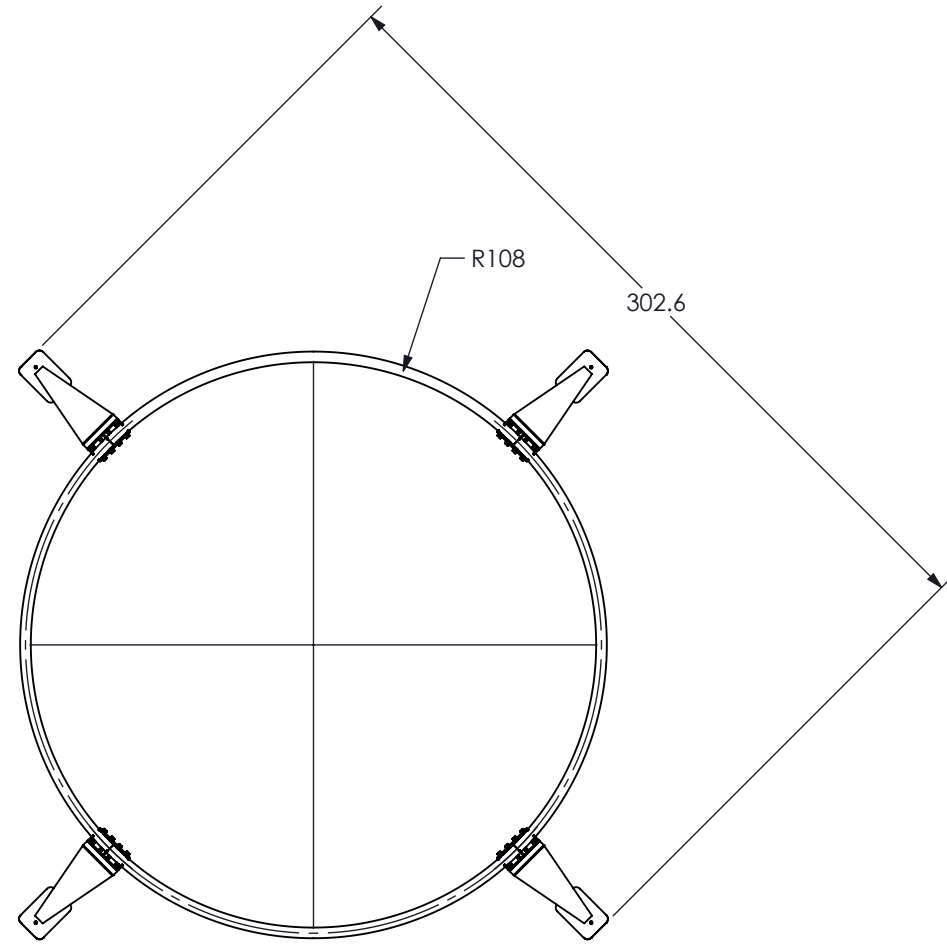
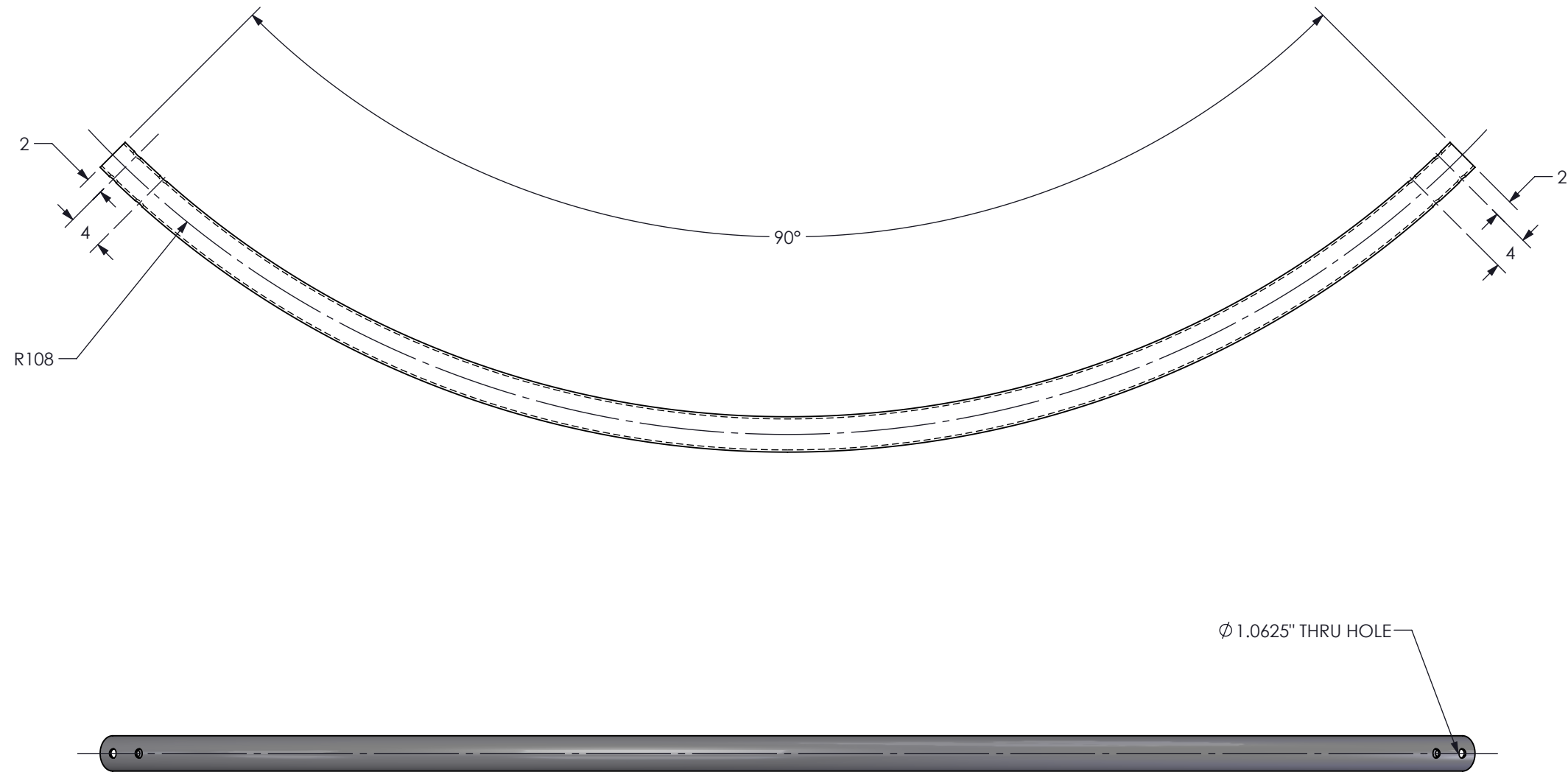

The attached information is the exclusive property of UGLS and is protected under the copyright laws of the United States and other countries. All persons to whom this information is shared agree that they will not make use of, or disclose to any third party, this information without the expressed written permission of UGLS. Any unauthorized use of this information may constitute a violation of the United States Copyright Act.

PROJECT:		JOB #:	PART #:	DRAWING #:	PART NAME:	VERSION:	TOLERANCES		PROTOTYPE FOR PROTOTYPE OR QUOTE ONLY	SHEET: 2 OF 9
MATERIAL: 4" DIAMETER TUBING		FINISH: PC SILVER	SCALE: 1:16	DATE: 8/29/2023	DRAWN BY: N.RUMSCHLAG		DECIMAL XXX = ± .015 XX = ± .030 X = ± .1	FRACTIONS = ± 1/32 ANGLE = ± 1/2°		

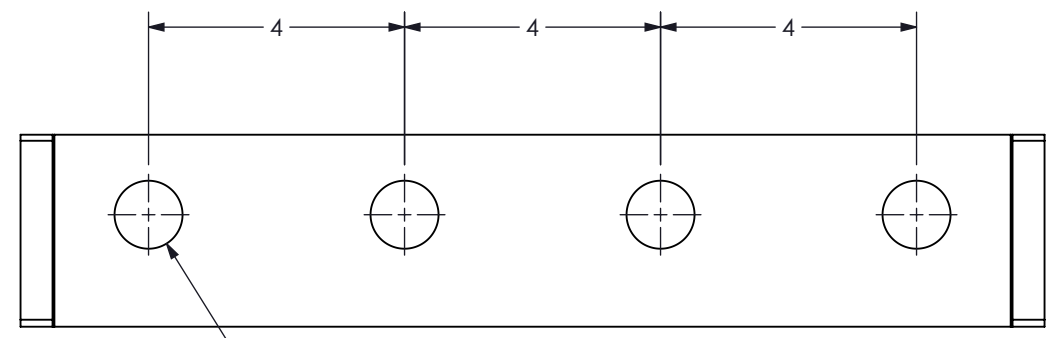
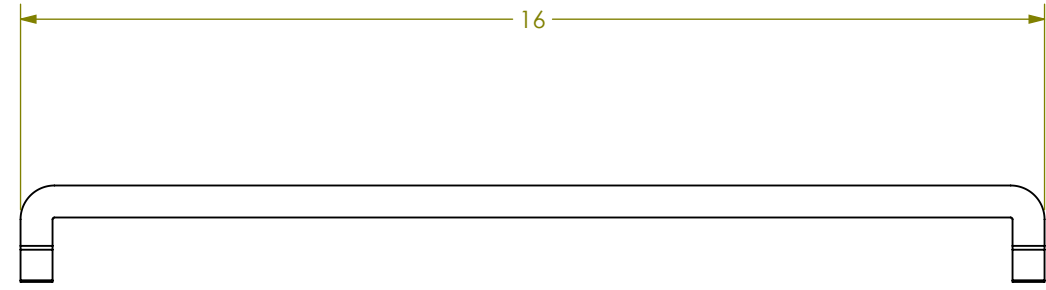
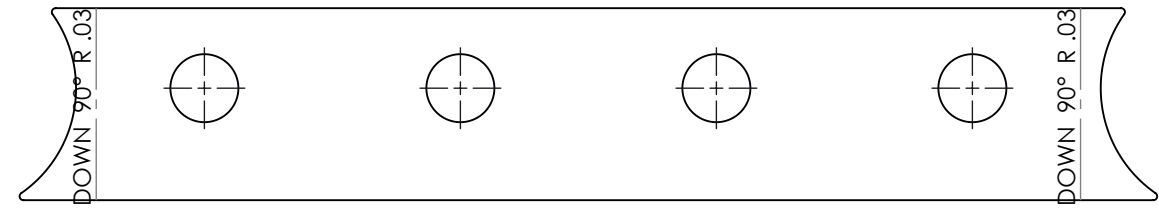

Ø1.1 THRU

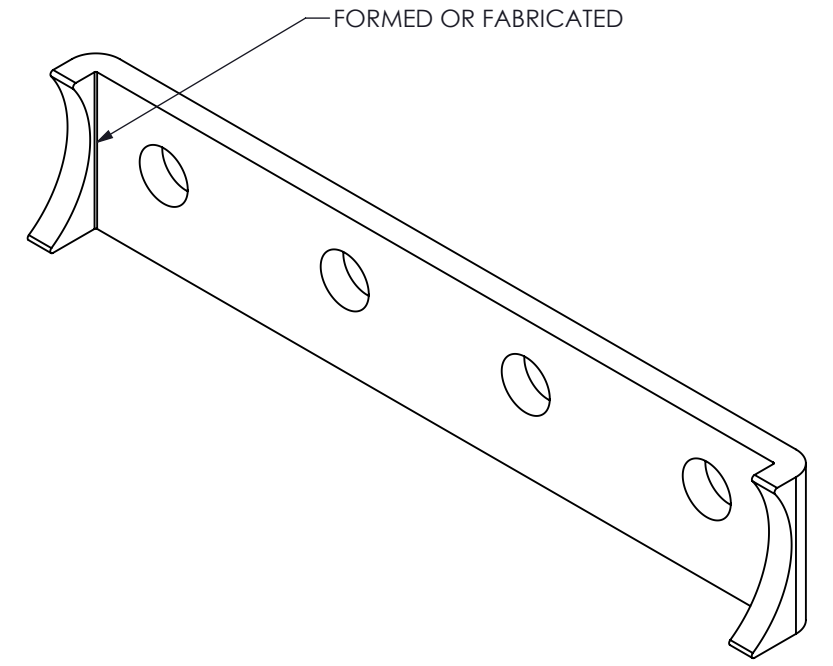
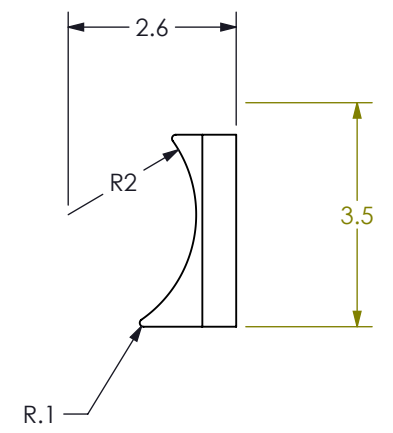

The attached information is the exclusive property of UGLS and is protected under the copyright laws of the United States and other countries. All persons to whom this information is shared agree that they will not make use of, or disclose to any third party, this information without the expressed written permission of UGLS. Any unauthorized use of this information may constitute a violation of the United States Copyright Act.

PROJECT:	JOB #:	PART #: 023001-M-007	DRAWING #:	PART NAME:	VERSION: V1	TOLERANCES DECIMAL: .XXX = ± .015 FRACTIONS: = ± 1/32 XX = ± .030 X = ± .1	ANGLE = ± 1/2°	PROTOTYPE FOR PROTOTYPE OR QUOTE ONLY	SHEET: 3 OF 9
MATERIAL: SINTRA	FINISH:	SCALE: 1:3	DATE: 8/29/2023	DRAWN BY: N.RUMSCHLAG					

ITEM NO.	PART NUMBER	DESCRIPTION	QTY.
1	023001-M-002	TOP PLATE	1
2	023001-M-003	BOTTOM PLATE	1
3	023001-M-004	MAIN PLATE	1
4	023001-M-005	FOOT PLATE	1
5	023001-M-006	CLAMP PLATE	1

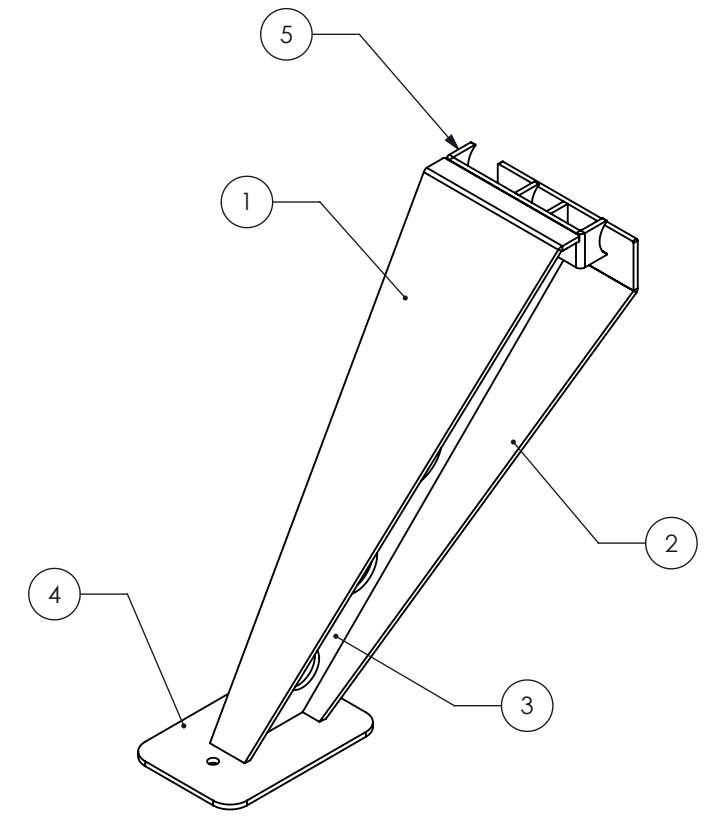
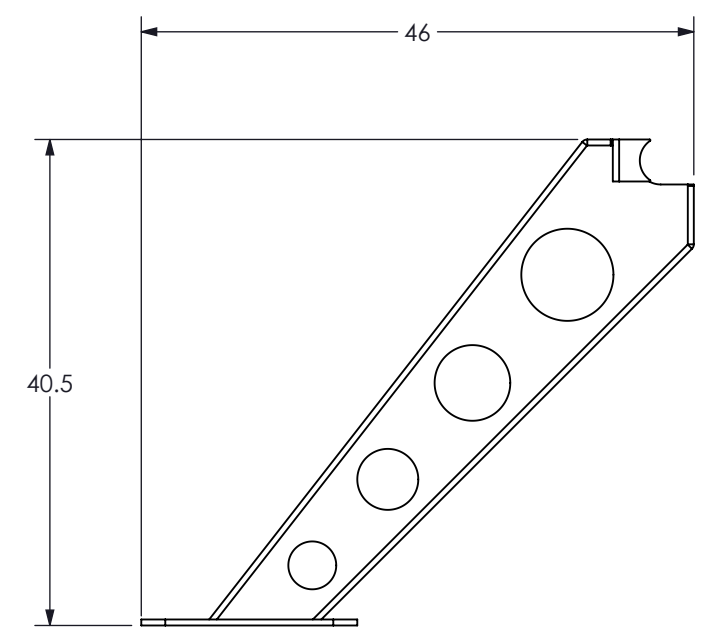
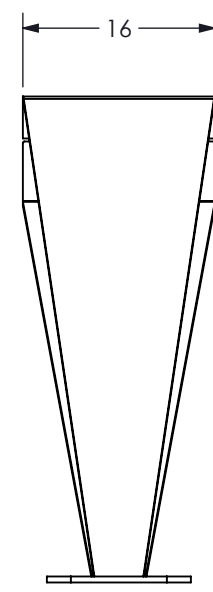
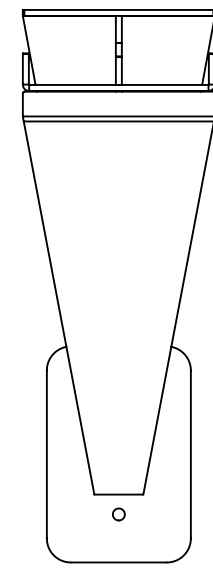

FULLY WELDED ASSEMBLY

The attached information is the exclusive property of UGLS and is protected under the copyright laws of the United States and other countries. All persons to whom this information is shared agree that they will not make use of, or disclose to any third party, this information without the expressed written permission of UGLS. Any unauthorized use of this information may constitute a violation of the United States Copyright Act.

PROJECT: UFO HOUSE	JOB #: 023001	PART #: 023001-MA-001	DRAWING #:	PART NAME: LEG WELDMENT	VERSION:	TOLERANCES DECIMAL: .015 FRACTIONS: 1/32 XXX = ±.015 ANGLE = ±1/2° XX = ±.030 X = ±.1	PROTOTYPE FOR PROTOTYPE OR QUOTE ONLY	SHEET: 4 OF 9
MATERIAL: SEE PART DETAILS	FINISH: PC SILVER	SCALE: 1:16	DATE: 8/29/2023	DRAWN BY: N.RUMSCHLAG				

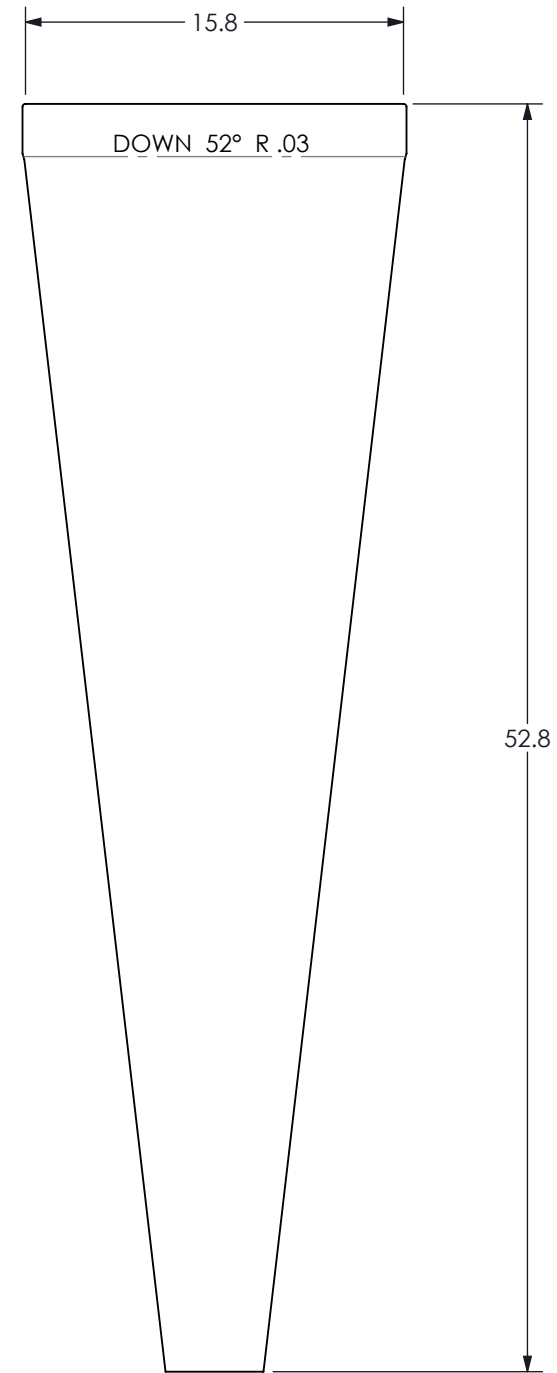
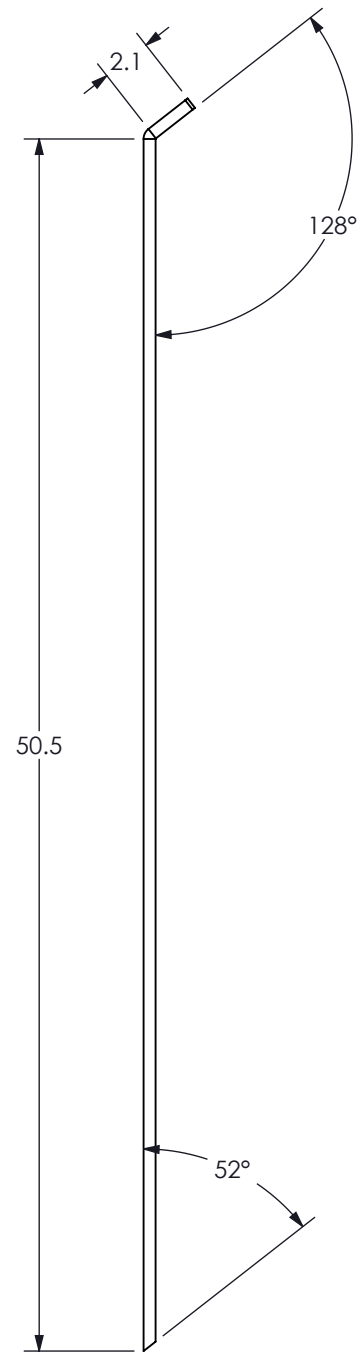
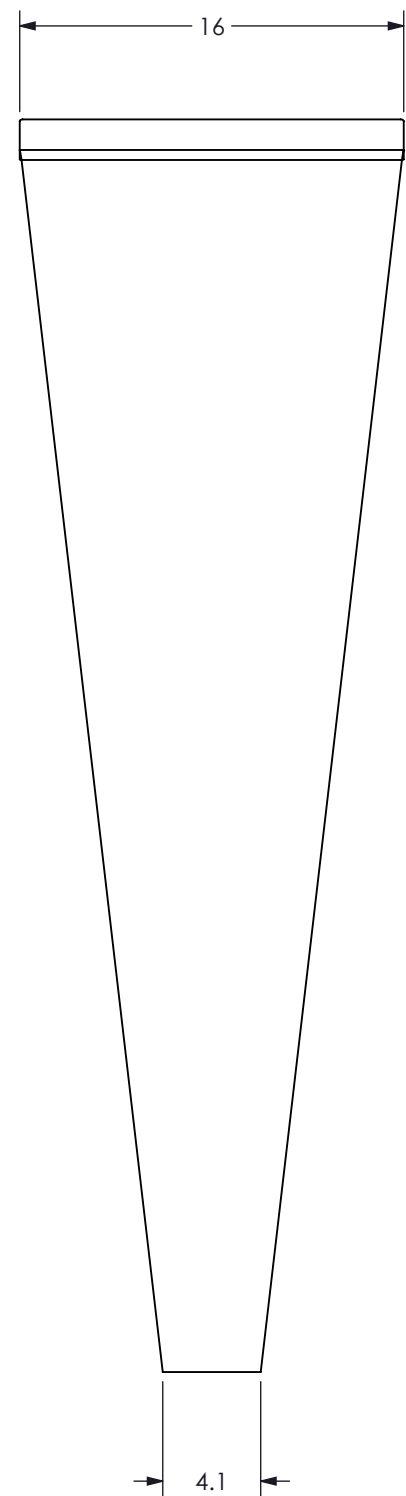

The attached information is the exclusive property of UGLS and is protected under the copyright laws of the United States and other countries. All persons to whom this information is shared agree that they will not make use of, or disclose to any third party, this information without the expressed written permission of UGLS. Any unauthorized use of this information may constitute a violation of the United States Copyright Act.

PROJECT: UFO HOUSE		JOB #: 023001	PART #: 023001-M-002	DRAWING #:	PART NAME: TOP PLATE	VERSION:	TOLERANCES DECIMAL: .XXX = ± .015 FRACTIONS: = ± 1/32 XX = ± .030 ANGLE = ± 1/2° X = ± 1		PROTOTYPE FOR PROTOTYPE OR QUOTE ONLY	SHEET: 5 OF 9
MATERIAL: 1/2" STEEL PLATE	FINISH: N/A	SCALE: 1:8	DATE: 8/29/2023	DRAWN BY: N.RUMSCHLAG						

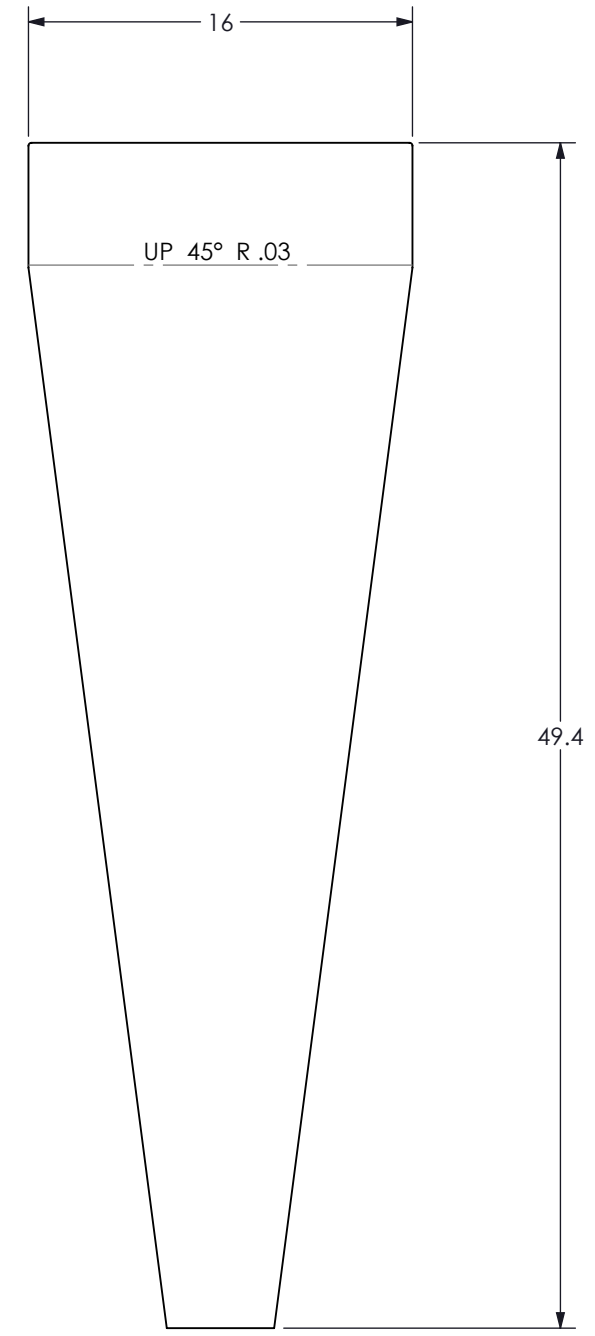
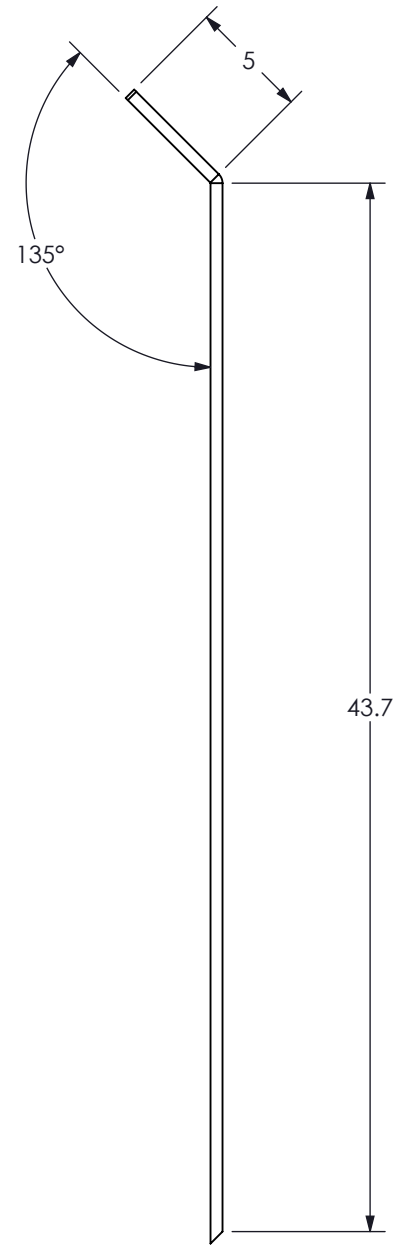
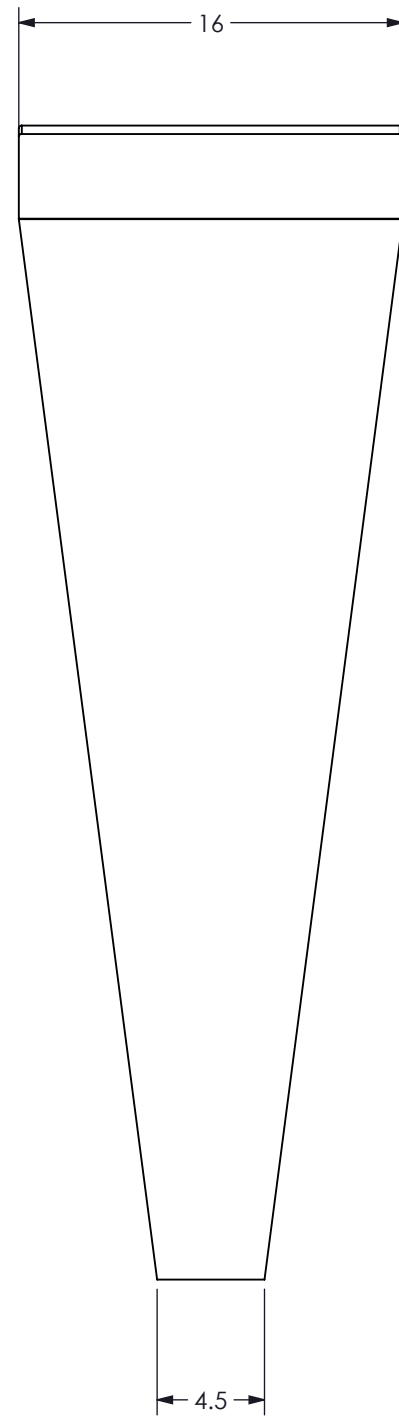

The attached information is the exclusive property of UGLS and is protected under the copyright laws of the United States and other countries. All persons to whom this information is shared agree that they will not make use of, or disclose to any third party, this information without the expressed written permission of UGLS. Any unauthorized use of this information may constitute a violation of the United States Copyright Act.

PROJECT:		JOB #: 023001	PART #: 023001-M-003	DRAWING #:	PART NAME: BOTTOM PLATE	VERSION:	TOLERANCES	PROTOTYPE FOR PROTOTYPE OR QUOTE ONLY	SHEET: 6 OF 9
MATERIAL: 1/2" STEEL PLATE	FINISH: N/A	SCALE: 1:8	DATE: 8/29/2023	DRAWN BY: N.RUMSCHLAG		DECIMAL FRACTIONS = ±1/32 .XXX = ± .015 ANGLE = ±1/2° .XX = ± .030 X = ±.1			

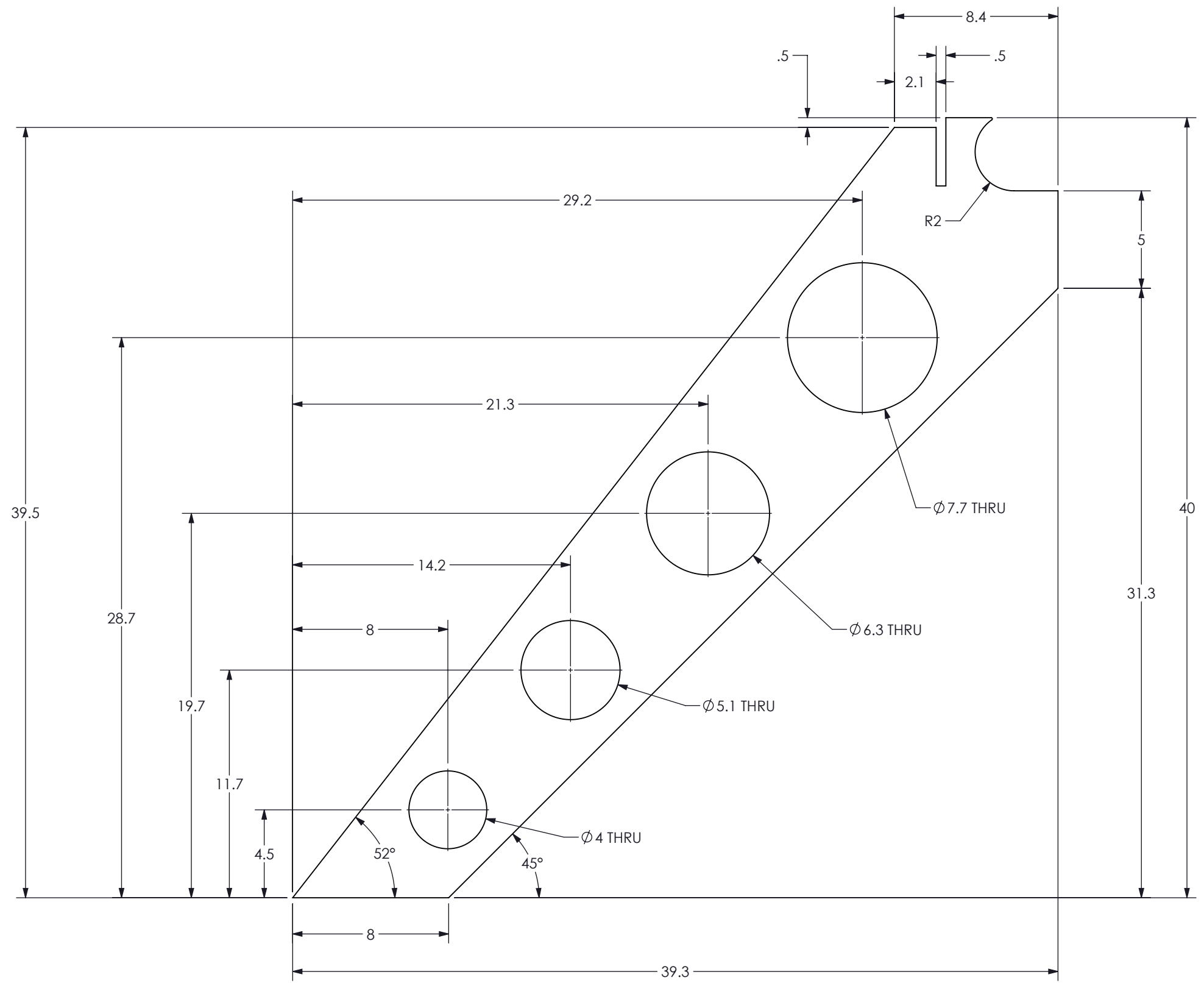

The attached information is the exclusive property of UGLS and is protected under the copyright laws of the United States and other countries. All persons to whom this information is shared agree that they will not make use of, or disclose to any third party, this information without the expressed written permission of UGLS. Any unauthorized use of this information may constitute a violation of the United States Copyright Act.

PROJECT: 023001	JOB #: 023001	PART #: 023001-M-004	DRAWING #: 023001-M-004	PART NAME: MAIN PLATE	VERSION: 1.0	TOLERANCES DECIMAL: .015 FRACTIONS: 1/32 XXX = ±.015 XX = ±.030 X = ±.1 ANGLE = ±1/2°	PROTOTYPE FOR PROTOTYPE OR QUOTE ONLY	SHEET: 7 OF 9
MATERIAL: 1/2" STEEL PLATE	FINISH: PC SILVER	SCALE: 1:6	DATE: 8/29/2023	DRAWN BY: N.RUMSCHLAG				

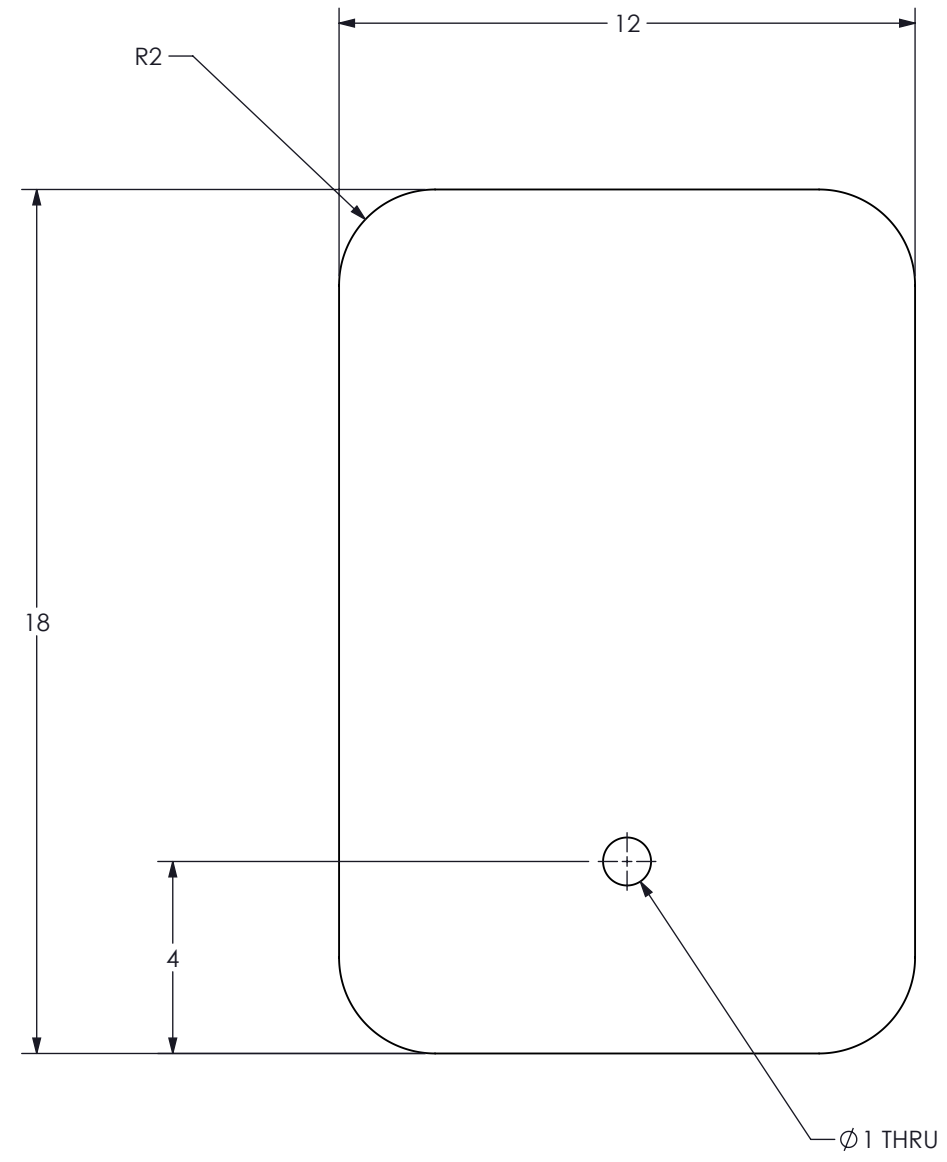

The attached information is the exclusive property of UGLS and is protected under the copyright laws of the United States and other countries. All persons to whom this information is shared agree that they will not make use of, or disclose to any third party, this information without the expressed written permission of UGLS. Any unauthorized use of this information may constitute a violation of the United States Copyright Act.

PROJECT: UFO HOUSE		JOB #: 023001	PART #: 023001-M-005	DRAWING #:	PART NAME: FOOT PLATE	VERSION:	TOLERANCES DECIMAL = ± .015 FRACTIONS = ± 1/32 XX = ± .030 ANGLE = ± 1/2° X = ± .1	PROTOTYPE FOR PROTOTYPE OR QUOTE ONLY	SHEET: 8 OF 9
MATERIAL: 1/2" STEEL PLATE	FINISH: N/A	SCALE: 1:4	DATE: 8/29/2023	DRAWN BY: N.RUMSCHLAG					

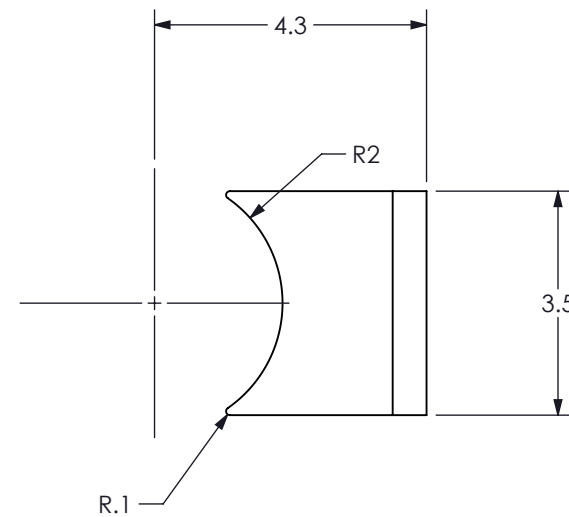
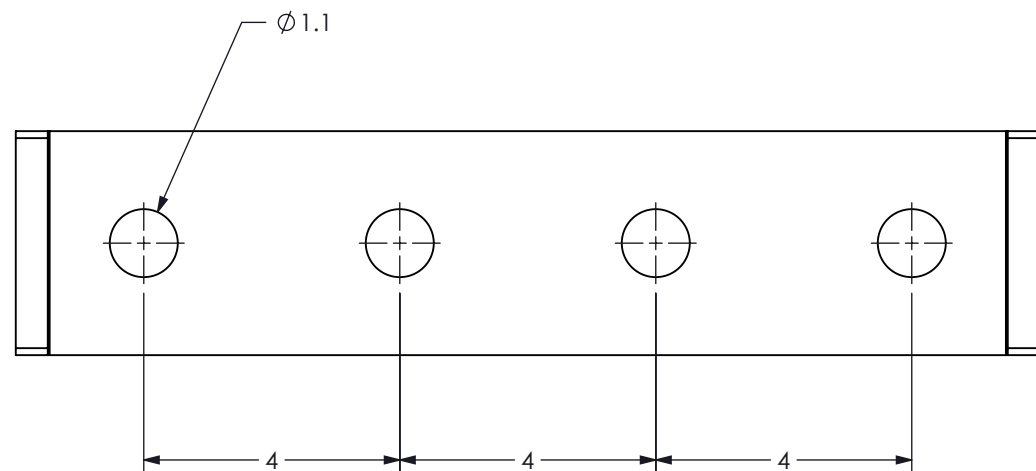
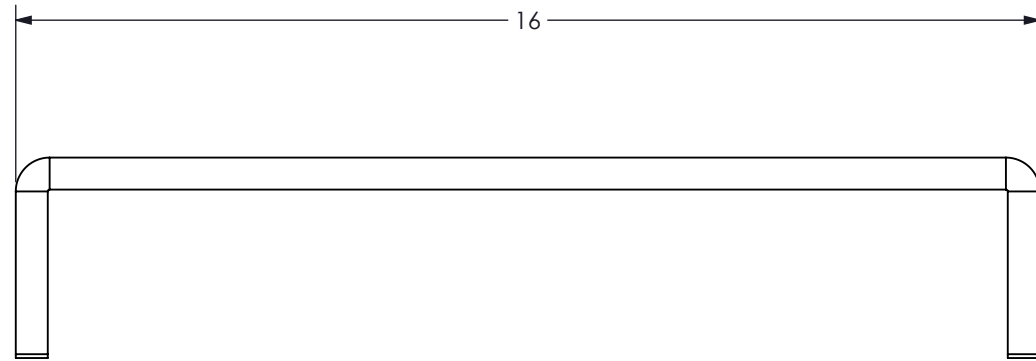
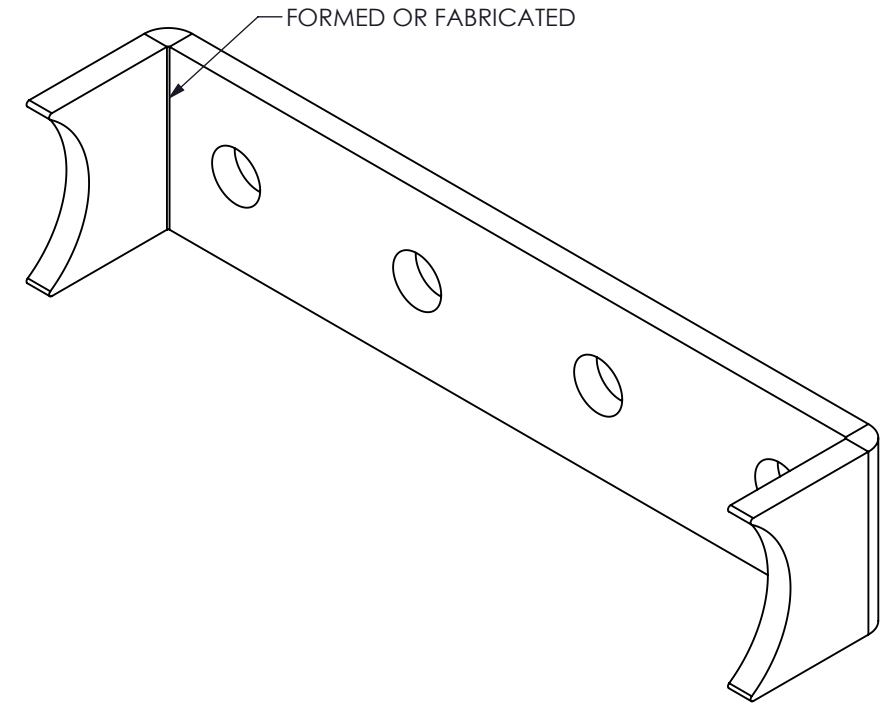
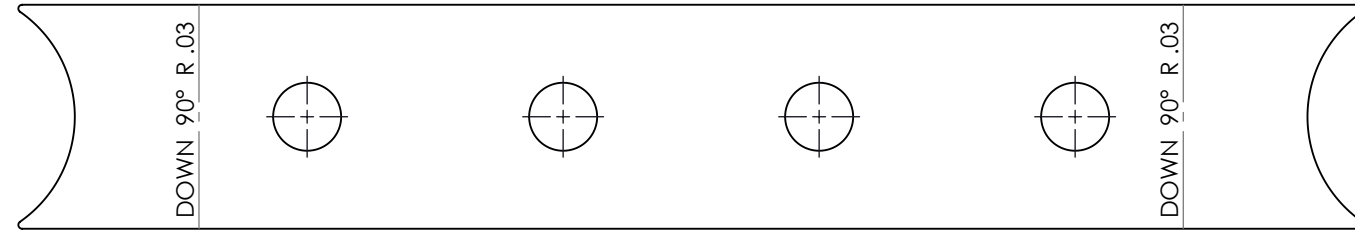

The attached information is the exclusive property of UGLS and is protected under the copyright laws of the United States and other countries. All persons to whom this information is shared agree that they will not make use of, or disclose to any third party, this information without the expressed written permission of UGLS. Any unauthorized use of this information may constitute a violation of the United States Copyright Act.

PROJECT: UFO HOUSE	JOB #: 023001	PART #: 023001-M-006	DRAWING #:	PART NAME: CLAMP PLATE	VERSION:	TOLERANCES DECIMAL: .XXX = ± .015 FRACTIONS: = ± 1/32 XX = ± .030 X = ± .1	ANGLE = ± 1/2°	PROTOTYPE FOR PROTOTYPE OR QUOTE ONLY	SHEET: 9 OF 9
MATERIAL: 1/2" STEEL PLATE	FINISH: N/A	SCALE: 1:3	DATE: 8/29/2023	DRAWN BY: N.RUMSCHLAG					